

# De-centered Lifting Point

## DLP

The Gunnebo Industries lifting point range provide a solution for every lifting and rigging operation, enabling improved operational efficiency. To choose the right lifting point for an operation can be a challenge, since most lifting points can be used for several purposes. Safety is our highest priority, therefore has each sold DLP been proof loaded 2.5 times the WLL.

The compact design of the De-centered Lifting Point (DLP) makes it ideal in narrow spaces such as corners and edge positions. The DLP is designed to make the link fold over the housing, allowing the lifting point to be almost completely stowed away when not in use. The closed, oblong link is also equipped with a "stay-up"-function for easy on-hooking, especially in limited spaces. This saves both the load from damage due to impact from hooks, as well as making rigging fast and easy. Thanks to the "stay-up"-function the DLP does not generate disturbing noises when attached to vibrating machines or vehicles. The hexagon bolt (RFID prepared) makes it easy to mount and dismount the DLP.



### Easy to mount & dismount

- The hexagon bolt makes it easy to mount and dismount the DLP.

### Rotates 360° & pivots 180°

- Making the DLP strong, flexible and reliable.

### "Stay-up" function

- Easy on-hooking.
- Saves load from damage caused by hooks.
- Does not generate disturbing noises when attached to vibrating machines or vehicles.

### Ideal in narrow spaces

- The compact design of the DLP makes it ideal in narrow spaces such as corners and edge positions.

### Available with extra long bolt

- The DLP is available with extra long bolts up to 10xd allowing the DLP to be tailer fitted for each application.

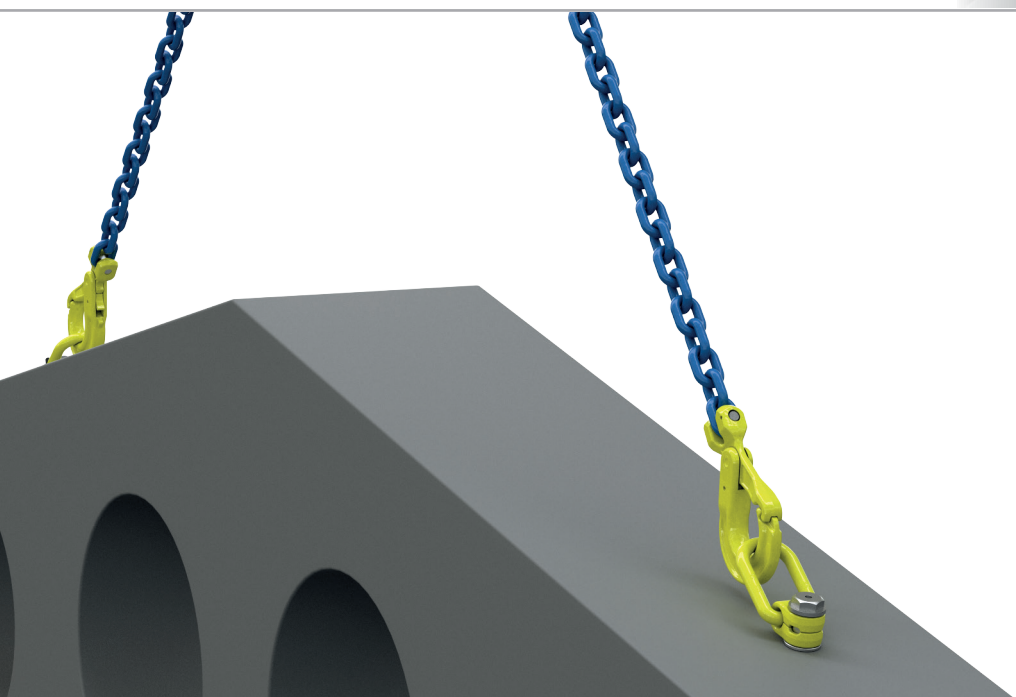

## Applications where the DLP is perfectly suited

### ✓ Angular lift

The DLP has been designed with the bow ring as close as possible to the base to which it is attached. This minimises torque and allows for higher WLL when lifting at an angle.

### ✓ Tilting under load

Tilting occurs in many lifts from raising wall sections to turning tools. The DLP is designed for easy and smooth tilting in any operation.

### ✓ Multiple part lift

The lifting point will always be positioned correctly in the lift thanks to the tilting and rotating functions of the lifting point.

## Example of typical applications

- Handling of tools for pressing, molding and forging.
- 4-point lifting beam for lifting containers
- Turning/lifting blades for wind turbines.
- Production and handling of turbo machinery.
- Handling of generators.
- Construction.
- Lashing and tie downs.

## De-centered Lifting Point DLP

| Art. no. | Code           | WLL tonnes* | Dimensions in mm |     |    |     |    |    |    |     |    |     |     |     | Weight Kgs |
|----------|----------------|-------------|------------------|-----|----|-----|----|----|----|-----|----|-----|-----|-----|------------|
|          |                |             | B                | C   | D  | E   | F  | G  | L  | L1  | M  | X   | Y   | Z   |            |
| Z102208  | DLP-M8 x 1.25  | 0.35        | 35               | 48  | 10 | 39  | 14 | 10 | 13 | 78  | 8  | 30  | 55  | 26  | 0.3        |
| Z102210  | DLP-M10 x 1.5  | 0.65        | 35               | 48  | 10 | 39  | 14 | 10 | 13 | 78  | 10 | 30  | 55  | 26  | 0.3        |
| Z102212  | DLP-M12 x 1.75 | 1.0         | 35               | 48  | 12 | 51  | 20 | 14 | 23 | 91  | 12 | 44  | 59  | 32  | 0.5        |
| Z102216  | DLP-M16 x 2    | 1.8         | 35               | 48  | 12 | 51  | 20 | 14 | 23 | 91  | 16 | 44  | 59  | 32  | 0.5        |
| Z102220  | DLP-M20 x 2.5  | 2.6         | 54               | 88  | 18 | 71  | 28 | 18 | 34 | 145 | 20 | 58  | 90  | 48  | 1.6        |
| Z102224  | DLP-M24 x 3    | 4.1         | 54               | 88  | 18 | 71  | 28 | 18 | 34 | 145 | 24 | 58  | 90  | 48  | 1.7        |
| Z102230  | DLP-M30 x 3.5  | 5.0         | 82               | 94  | 26 | 104 | 39 | 27 | 53 | 182 | 30 | 88  | 122 | 75  | 5.0        |
| Z102236  | DLP-M36 x 4    | 7.0         | 82               | 94  | 26 | 104 | 39 | 27 | 53 | 182 | 36 | 88  | 122 | 75  | 5.2        |
| Z102242  | DLP-M42 x 4.5  | 15.0        | 100              | 103 | 36 | 136 | 54 | 34 | 73 | 216 | 42 | 113 | 156 | 110 | 11.6       |
| Z102248  | DLP-M48 x 5    | 20.0        | 100              | 103 | 36 | 136 | 54 | 34 | 73 | 216 | 48 | 113 | 156 | 110 | 11.9       |

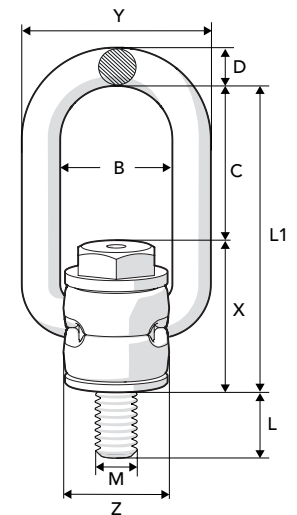

## DLP with UNC thread

| Art. no. | Code             | WLL tonnes* | Dimensions in mm |     |    |     |    |    |    |     |     |     |     |        | M inch | Weight kgs |
|----------|------------------|-------------|------------------|-----|----|-----|----|----|----|-----|-----|-----|-----|--------|--------|------------|
|          |                  |             | B                | C   | D  | E   | F  | G  | L  | L1  | X   | Y   | Z   |        |        |            |
| Z102308  | DLP-5/16"-18 UNC | 0.35        | 35               | 48  | 10 | 39  | 14 | 10 | 13 | 78  | 30  | 55  | 26  | 5/16"  | 0.3    |            |
| Z102310  | DLP-3/8"-16 UNC  | 0.60        | 35               | 48  | 10 | 39  | 14 | 10 | 13 | 78  | 30  | 55  | 26  | 3/8"   | 0.3    |            |
| Z102312  | DLP-1/2"-13 UNC  | 1.0         | 35               | 48  | 12 | 51  | 20 | 14 | 23 | 91  | 44  | 59  | 32  | 1/2"   | 0.5    |            |
| Z102316  | DLP-5/8"-11 UNC  | 1.6         | 35               | 48  | 12 | 51  | 20 | 14 | 23 | 91  | 44  | 59  | 32  | 5/8"   | 0.5    |            |
| Z102320  | DLP-3/4"-10 UNC  | 2.2         | 54               | 88  | 18 | 71  | 28 | 18 | 34 | 145 | 58  | 90  | 48  | 3/4"   | 1.6    |            |
| Z102321  | DLP-7/8"-9 UNC   | 2.6         | 54               | 88  | 18 | 71  | 28 | 18 | 34 | 145 | 58  | 90  | 48  | 7/8"   | 1.6    |            |
| Z102324  | DLP-1"-8 UNC     | 4.1         | 54               | 88  | 18 | 71  | 28 | 18 | 34 | 145 | 58  | 90  | 48  | 1"     | 1.7    |            |
| Z102330  | DLP-1 1/4"-7 UNC | 5.0         | 82               | 94  | 26 | 104 | 39 | 27 | 53 | 182 | 88  | 122 | 75  | 1 1/4" | 5.5    |            |
| Z102336  | DLP-1 1/2"-6 UNC | 7.0         | 82               | 94  | 26 | 104 | 39 | 27 | 53 | 182 | 88  | 122 | 75  | 1 1/2" | 5.7    |            |
| Z102342  | DLP-1 3/4"-5 UNC | 15.0        | 100              | 103 | 36 | 136 | 54 | 34 | 73 | 216 | 113 | 156 | 110 | 1 3/4" | 11.7   |            |
| Z102348  | DLP-2"-4.5 UNC   | 20.0        | 100              | 103 | 36 | 136 | 54 | 34 | 73 | 216 | 113 | 156 | 110 | 2"     | 12.1   |            |

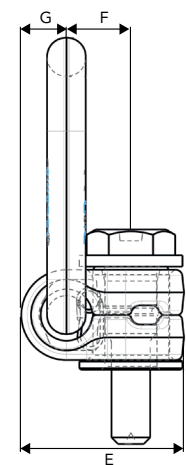

## Working Load Limits\* - DLP

Symmetric Load (tonnes)

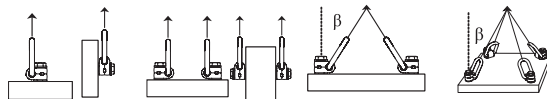

| No. of legs       | 1             |                              | 2                            |       | 2 symmetric |       | 3 & 4 symmetric |          | Tightening torque | Spanner size |
|-------------------|---------------|------------------------------|------------------------------|-------|-------------|-------|-----------------|----------|-------------------|--------------|
|                   | Angle $\beta$ | $0^\circ < \beta < 90^\circ$ | $0^\circ < \beta < 90^\circ$ | 0-45° | 45-60°      | 0-45° | 45-60°          |          |                   |              |
| DLP-M8 x 1.25     | 0.35          | 0.35                         | 0.70                         | 0.5   | 0.35        | 0.7   | 0.5             | 10 Nm    | 13 mm             |              |
| DLP 5/16"-18 UNC  | 0.35          | 0.35                         | 0.70                         | 0.5   | 0.35        | 0.7   | 0.5             | 7 Ft.Lbs | 1/2"              |              |
| DLP-M10 x 1.5     | 0.65          | 1.30                         | 0.9                          | 0.65  | 1.4         | 1.0   | 15 Nm           | 13 mm    |                   |              |
| DLP 3/8"-16 UNC   | 0.60          | 1.20                         | 0.8                          | 0.60  | 1.3         | 1.0   | 11 Ft.Lbs       | 1/2"     |                   |              |
| DLP-M12 x 1.75    | 1.0           | 2.0                          | 1.4                          | 1.0   | 2.1         | 1.5   | 27 Nm           | 24 mm    |                   |              |
| DLP 1/2"-13 UNC   | 1.0           | 2.0                          | 1.4                          | 1.0   | 2.1         | 1.5   | 20 Ft.Lbs       | 15/16"   |                   |              |
| DLP-M16 x 2       | 1.8           | 3.6                          | 2.5                          | 1.8   | 3.7         | 2.7   | 60 Nm           | 24 mm    |                   |              |
| DLP 5/8"-11 UNC   | 1.6           | 3.2                          | 2.2                          | 1.6   | 3.3         | 2.4   | 44 Ft.Lbs       | 15/16"   |                   |              |
| DLP-M20 x 2.5     | 2.6           | 5.2                          | 3.5                          | 2.6   | 5.4         | 3.9   | 90 Nm           | 32 mm    |                   |              |
| DLP -3/4"-10 UNC  | 2.2           | 4.4                          | 3.0                          | 2.2   | 4.6         | 3.3   | 66 Ft.Lbs       | 1 5/16"  |                   |              |
| DLP -7/8"-9 UNC   | 2.6           | 5.2                          | 3.5                          | 2.6   | 5.4         | 3.9   | 66 Ft.Lbs       | 1 5/16"  |                   |              |
| DLP-M24 x 3       | 4.1           | 8.2                          | 5.7                          | 4.1   | 8.6         | 6.1   | 135 Nm          | 32 mm    |                   |              |
| DLP -1"-8 UNC     | 4.1           | 8.2                          | 5.7                          | 4.1   | 8.6         | 6.1   | 100 Ft.Lbs      | 1 5/16"  |                   |              |
| DLP-M30 x 3.5     | 5.0           | 10.0                         | 7.0                          | 5.0   | 10.5        | 7.5   | 270 Nm          | 55 mm    |                   |              |
| DLP -1 1/4"-7 UNC | 5.0           | 10.0                         | 7.0                          | 5.0   | 10.5        | 7.5   | 200 Ft.Lbs      | 2 1/4"   |                   |              |
| UNC               |               |                              |                              |       |             |       |                 |          |                   |              |
| DLP-M36 x 4       | 7.0           | 14.0                         | 9.8                          | 7.0   | 14.7        | 10.5  | 320 Nm          | 55 mm    |                   |              |
| DLP -1 1/2"-6 UNC | 7.0           | 14.0                         | 9.8                          | 7.0   | 14.7        | 10.5  | 236 Ft.Lbs      | 2 1/4"   |                   |              |
| UNC               |               |                              |                              |       |             |       |                 |          |                   |              |
| DLP-M42 x 4.5     | 15.0          | 30.0                         | 21.0                         | 15.0  | 31.5        | 22.5  | 600 Nm          | 75 mm    |                   |              |
| DLP -1 3/4"-5 UNC | 15.0          | 30.0                         | 21.0                         | 15.0  | 31.5        | 22.5  | 440 Ft.Lbs      | 3"       |                   |              |
| UNC               |               |                              |                              |       |             |       |                 |          |                   |              |
| DLP-M48 x 5       | 20.0          | 40.0                         | 28.0                         | 20.0  | 42.0        | 30.0  | 800 Nm          | 75 mm    |                   |              |
| DLP -2"-4.5 UNC   | 20.0          | 40.0                         | 28.0                         | 20.0  | 42.0        | 30.0  | 590 Ft.Lbs      | 3"       |                   |              |

\* Safety factor 4:1

## Extra Long Bolt for DLP\*\*

| Art. no.  | Bolt         | Protrusion L (mm) | Weight (kgs) |
|-----------|--------------|-------------------|--------------|
| Z1022081L | M8 x 1.25    | 98                | 0.06         |
| Z1022101L | M10 x 1.5    | 98                | 0.08         |
| Z1022121L | M12 x 1.75   | 78                | 0.14         |
| Z1022161L | M16 x 2      | 78                | 0.20         |
| Z1022201L | M20 x 2.5    | 84                | 0.46         |
| Z1022241L | M24 x 3      | 84                | 0.50         |
| Z1022301L | M30 x 3.5    | 295               | 2.40         |
| Z1022361L | M36 x 4      | 295               | 3.00         |
| Z1022421L | M42 x 4.5    | 283               | 5.00         |
| Z1022481L | M48 x 5      | 283               | 6.00         |
| Z1023081L | UNC 5/16"-18 | 98                | 0.06         |
| Z1023101L | UNC 3/8"-16  | 98                | 0.07         |
| Z1023121L | UNC 1/2"-13  | 78                | 0.16         |
| Z1023161L | UNC 5/8"-11  | 78                | 0.20         |
| Z1023201L | UNC 3/4"-10  | 84                | 0.44         |
| Z1023211L | UNC 7/8"-9   | 84                | 0.50         |
| Z1023241L | UNC 1"-8     | 84                | 0.60         |
| Z1023301L | UNC 1 1/4"-7 | 295               | 2.50         |
| Z1023361L | UNC 1 1/2"-6 | 295               | 3.30         |
| Z1023421L | UNC 1 3/4"-5 | 283               | 5.40         |
| Z1023481L | UNC 2"-4.5   | 283               | 6.40         |

\*\* When using extra long bolt, make sure to use nut/washer of min. strength rating 10.9, ISO 898-1.